

DIAMOND

Fiber Optic Components

CABLE ASSEMBLIES AND ADAPTERS

The E-2000™ Crimp&Cleave System is designed for field termination of 200/230 µm HCS-Fiber. Typical uses include point to point installations over short distance requiring low data rate transmission, industrial applications such as machine controls or sensors. All of the features, users have come to expect from the E-2000™ family, are available from the E-2000™ Crimp&Cleave, including: ease of installation, integrated protection caps, color coding, mechanical keying and excellent vibration resistance. Diamond E-2000™ components are EtO-sterilizable and, with optional O-ring seals, IP65-rated, meeting today's requirements for safety, reliability, and quality in biomedical markets and applications subject to special environmental conditions.

FEATURES AND BENEFITS

- ▶ Injection molded housing (UL 94 V0 flammability rating)
 - Rugged, cost-saving construction
 - Connector housing totally encloses ferrule to optimally protect it from dust, contaminants and scratches
- ▶ Positive latching mechanism
 - Superior retention under axial loads
- ▶ Spring-loaded shutters
 - Engage automatically to protect personnel from eye-damaging laser radiation
 - Angled, anti-reflection surface ensures low reflectance in unmated state
- ▶ Integrated protective caps
 - Automatically protect personnel from eye-damaging laser radiation.
 - Close automatically upon extraction to protect ferrule from dust and scratches
- ▶ Interchangeable color-coded and mechanically keyed thumb-latches and frames
 - Permit clear and unmistakable identification of lines on crowded patch panels
 - Guard against improper connections
- ▶ Compact, rectangular footprint; push-pull design
 - Permits dense packing
- ▶ High modular connector-system
 - Single channel components can be upgraded to duplex through the use of a simple clip-bridge and an extended thumb-latch
- ▶ Cutout for E-2000™ LED connectors

AVAILABLE AS

- ▶ Connector set, (to be terminated with Diamond special equipment)

SPECIFICATIONS

Insertion Loss	0.8 dB typ.
Service life	1000 mate/demate cycles (According to field experience)
Operating temperature	-40/+85° C*
Storage temperature	-40/+90° C*

* May be further limited by cable specifications



DIAMOND SA • Via dei Patrizi 5 • CH-6616 Losone • Switzerland
Tel. +41 91 785 45 45 • Fax +41 91 785 45 00 • e-mail info@diamond-fo.com
www.diamond-fo.com

E-2000™ Crimp&Cleave

MULTIMODE HCS



TERMINATION KIT

The E-2000™ Crimp&Cleave kit includes all tooling, materials, and instructions to allow the installer to quickly and easily install connectors.

ORDER INFORMATION

Please refer to the Crimp&Cleave Termination Kit P/N list.

BASIC KIT CONTENTS

- 1 Crimp tool
- 2 Fiber stripper
- 3 Fiber cleaver
- 4 Cable stripper
- 5 Scissors
- 6 E-2000™ pliers

OTHER PLIERS* FOR HOUSING ASSEMBLY

SC pliers
FC pliers
ST™ pliers

* Separately order



Dimensions: ca. 455 x 368 x 166 mm
Weight: ca. 5 Kg (11 lbs)

E-2000™ IP65 CONNECTION

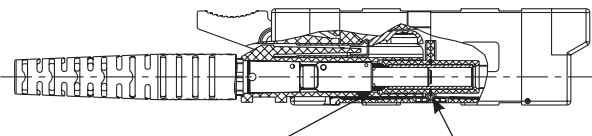

Optional O-ring seals on E-2000™ connectors and mating adapters result in sealed, IP65-rated connections

Specifications subject to change without notice

BDD 1950102 02_12

E-2000™ C&C SIMPLEX TYPES AND DIMENSIONS

Connectors 900 µm - 3 mm boot style

Available types: **E-2000™ Crimp&Cleave simplex**

Ferrule material: Zirconia/copper-nickel alloy insert

External parts: Plastic black

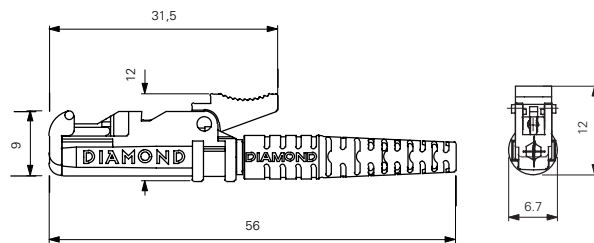

ADAPTER TYPES AND DIMENSIONS

Available types: **E-2000™ simplex Crimp&Cleave mating adapter**

Material: Plastic black

Mating sleeve: Zirconia

For complete product descriptions, please refer to the part-specific E-2000™ Simplex datasheet.

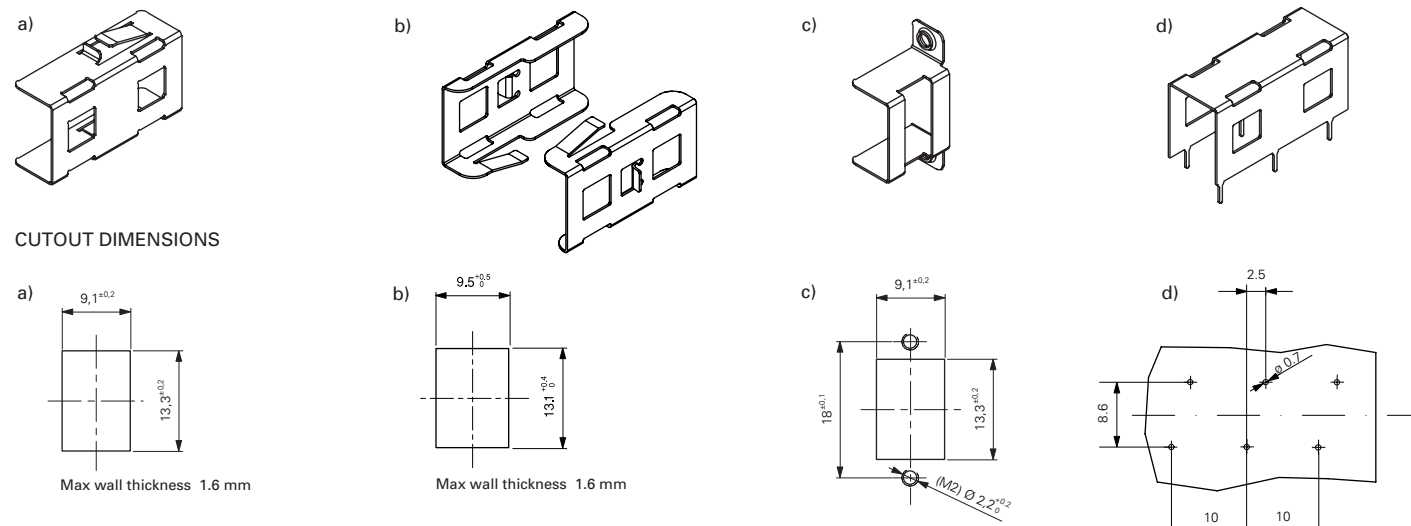
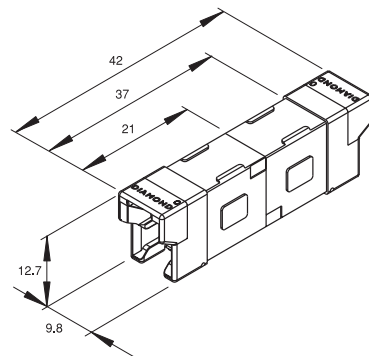

COLOR KEYING

The E-2000™ system permits the user to specify the color of the thumb-latch and the mating adapter frame so that different line types, uses, destinations and points of origin, etc. can be readily identified.

The thumb-latch and frame are available in eight distinct colors:

- | | |
|------------------|-----------|
| 1. Blue | 5. Orange |
| 2. Beige (White) | 6. Yellow |
| 3. Black | 7. Green |
| 4. Red | 8. Violet |

MECHANICAL KEYING

Additionally, it will become increasingly necessary to guard against improper connection in multiple-service patch facilities. The E-2000™ system permits the inclusion of a mechanical keying mechanism to ensure channel differentiation.

The mechanical keying options are also color-coded as follows:

- | | |
|-----------|------------------|
| 1. Red | 4. Orange |
| 2. Brown | 5. Violet |
| 3. Yellow | 6. Beige (White) |

NOTE Diamond standard colors for connector bodies, cable boots and mating adapter housings are black. Other colors available upon request.

E-2000™ C&C COMPACT TYPES AND DIMENSIONS

Connectors 900 µm - 3 mm boot style

Available types: **E-2000™ Crimp&Cleave compact**

Ferrule material: Zirconia/copper-nickel alloy insert

External parts: Plastic black

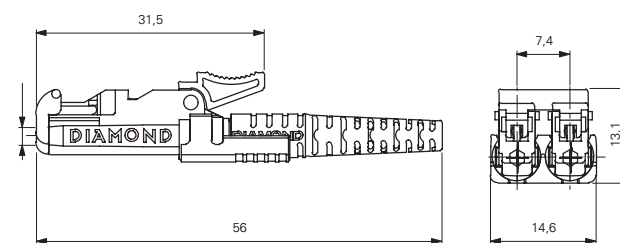

ADAPTER TYPES AND DIMENSIONS

Available types: **E-2000™ compact Crimp&Cleave mating adapter**

Material: Plastic black

Mating sleeve: Zirconia

For complete product description, please refer to the part-specific E-2000™ Compact datasheet.

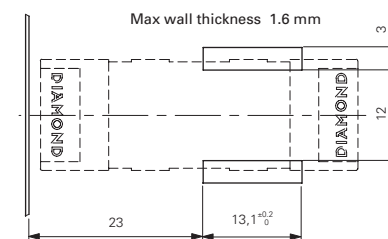
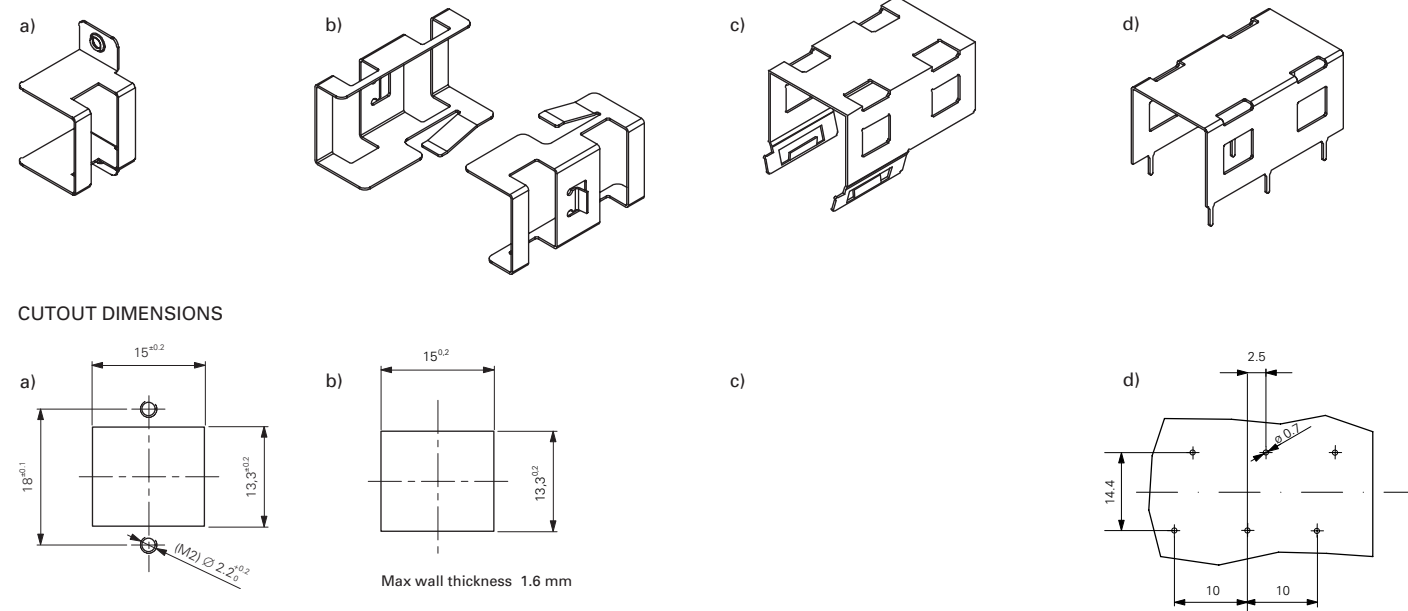
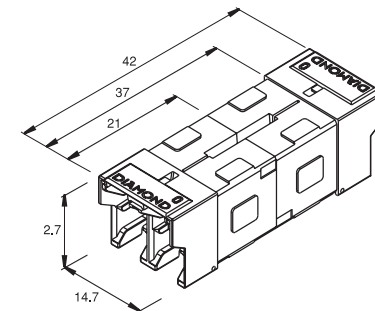

ORDER INFORMATION

To order connector sets, mating adapters and fixing clips, please refer to the part numbers provided in the enclosed P/N list.