

DIAMOND

Fiber Optic Components

NETWORK ACCESSORIES

DESCRIPTION

Optical Sacrificial Interfaces are compact, in-line, male-to-female components, especially used in laboratory and field test equipment to protect front panel connector end-faces from the damage and contamination of repeated mating and de-mating. The use of sacrificial interfaces avoids costly instrument re-calibration that usually requires the equipment to be returned to the manufacturer or specialized service centers and eliminates equipment down time. The sacrificial interface can be connected on the front of the panel instrument to facilitate user access (Fig. 1), or inside it (Fig. 2) for instrument manufacturers who prefer to provide service and maintenance themselves. Diamond Sacrificial Interfaces are available for MM and SM fibers, with different end-face geometries: PC/PC, APC/APC, to a wide range of international connector standards.

The ACA (Active Core Alignment) technology used in the Diamond Sacrificial Interfaces ensures minimal additional insertion loss and back reflections combined with exceptional repeatability due to the ultra-high tolerance Titanium interfaces. UGTs Optical Transition Adapters (male/female) are also space saving in-line components, mainly deployed to connect different connector geometries, (eg. from 0° PC connectors to 8° angle-polished APC connector or the reverse).

Ferrule type

Standard $\varnothing 2.5\text{mm}$, 1.25mm Zirconia/metal insert.
Except for ST™ $\varnothing 2.5\text{mm}$ tungsten carbide.

SPECIFICATIONS

	SM G. 652D	MM	UNITS	TEST CONDITIONS
Insertion Loss (IL)*	max 0.7 dB	max 0.7 dB	dB	IEC 61300-3-4; $\lambda = 1300/1550\text{nm}$ SM - 850/1300nm MM
Return Loss (RL)	PC min 45 / APC min 70**	min 35 dB	dB	IEC 61300-3-6; $\lambda = 1300/1550\text{nm}$ SM - 850/1300nm MM
Repeatability of IL	max ± 0.3 (DiaLink max ± 0.1)		dB	IEC 61300-2-2; $\lambda = 1300/1550\text{nm}$ SM - 850/1300nm MM
Service life	500 mate/demate cycles			
Operating temperature	-40/+85		°C	
Storage temperature	-40/+90		°C	

* Total Insertion Loss. Additional IL due to modal noise max 0.5 dB

** Measured with high resolution reflectometer HP

Other fibers available upon request

TYPES AND DIMENSIONS

E-2000™

Available types:

- UGT E-2000™ APC/PC SM
- UGT E-2000™ PC/APC SM
- SI E-2000™ APC/APC SM
- SI E-2000™ PC/PC SM or MM

External parts: Plastic (blue for PC and green for APC side; beige for MM)

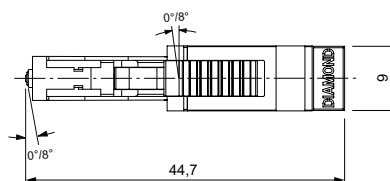

STANDARD COLOR FOR E-2000™

Version	SM APC/PC	SM PC/APC	SM PC/PC	SM APC/APC	MM PC/PC
Latch/Frame	green/blue	blue/green	blue/blue	green/green	beige/beige

Other latch and frame colors or frames with mechanical keying available upon request. (latch + frame of same color).

Please refer to the part-specific Color and mechanical Keying of E-2000™ Simplex datasheet.



DIAMOND SA • Via dei Patrizi 5 • CH-6616 Losone • Switzerland
Tel. +41 91 785 45 45 • Fax +41 91 785 45 00 • e-mail info@diamond-fo.com

www.diamond-fo.com

Sacrificial Interface (SI) and UGT

(Optical Transition Adapters)

SINGLE MODE APC/PC - PC/APC
PC/PC - APC/APC
MULTIMODE PC/PC

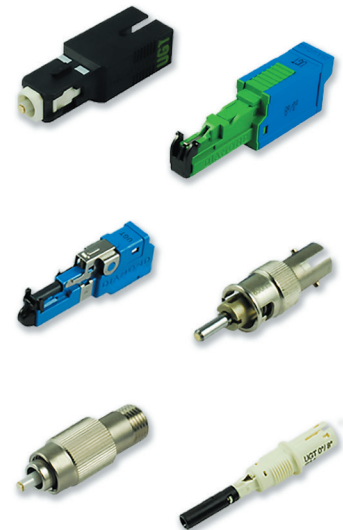

Fig. 1

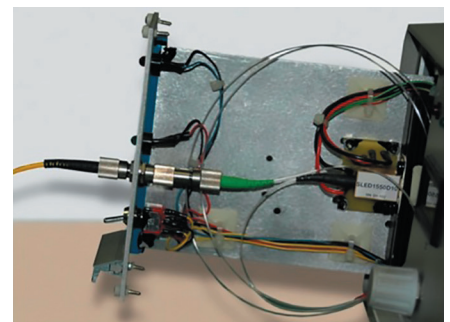

Fig. 2

Specifications subject to change without notice

BDD 1950167 04_16

F-3000™

Available types: **UGT F-3000™ APC/PC SM**
UGT F-3000™ PC/APC SM
SI F-3000™ APC/APC SM
SI F-3000™ PC/PC SM or MM

External parts: Black plastic
 for SM with marking for PC and APC side;
 Beige plastic for MM

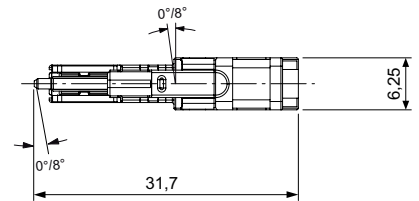
**SC**

Available types: **UGT SC APC/PC SM**
UGT SC PC/APC SM
SI SC APC/APC SM
SI SC PC/PC SM or MM

External parts: Black plastic
 for SM with marking for PC and APC side;
 Beige plastic for MM

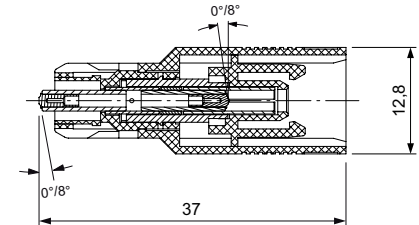
**FC**

Available types: **UGT FC APC/PC SM**
UGT FC PC/APC SM
SI FC APC/APC SM
SI FC PC/PC SM or MM

External parts: Metal
 with marking for SM PC and APC side
 and for MM 50µm /62.5µm

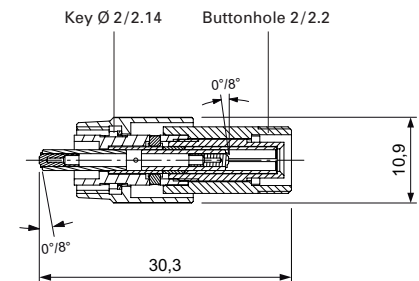
**ST™**

Available types: **SI ST™ PC/PC SM or MM**

External parts: Metal
 with marking for SM and for MM 50µm /62.5µm

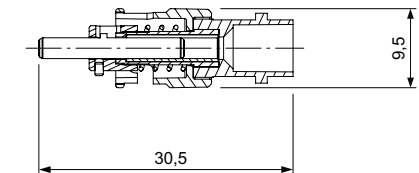
**DiaLink**

Available types: **UGT APC/PC**
UGT PC/PC
SI APC/APC
SI PC/PC

External parts: Plastic
 with marking for SM PC and APC side
 and for MM 50µm /62.5µm

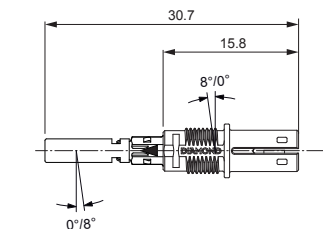
**ORDER INFORMATION**

Please refer to the part numbers provided in the separate P/N list.

For other configurations, please contact your nearest local Diamond representative or fill in the contact form available on the www.diamond-fo.com website.

Other versions upon request.